

# B AC Motors

S.C. C&B Motor 40W (□ 90mm)

## 40W Speed Control Clutch & Brake Motor 40W(□ 90mm)

### Motor 사양

Model		Output	Voltage	Frequency	Poles	Duty	Speed Range	Starting Torque		Permissible Torque				Capacitor
9CSDG*-40G-C(L): Gear Type Shaft								W	V	Hz	r/min	kgfcm	N.m	
Connector Type	Lead Wire Type	kgfcm	N.m	kgfcm	N.m	kgfcm	N.m							
9CSDG1(A)-40□-C	9CSDG1(A)-40□-L	40	1φ110	60	4	Cont.	90-1700	1.80	0.180	2.70	0.270	0.80	0.080	10.0 / 250
9CSDGB-40□-C	9CSDGB-40□-L	40	1φ100	50	4	Cont.	90-1400	1.60	0.160	2.50	0.250	0.70	0.070	10.0 / 250
				60			90-1700	1.60	0.160	2.50	0.250	0.70	0.070	
9CSDGC-40□-C	9CSDGC-40□-L	40	1φ200	50	4	Cont.	90-1400	1.90	0.190	3.00	0.300	0.80	0.080	3.0 / 450
				60			90-1700	1.90	0.190	2.80	0.280	0.80	0.080	
9CSDG2(D)-40□-C	9CSDG2(D)-40□-L	40	1φ220	60	4	Cont.	90-1700	1.80	0.180	2.70	0.270	0.80	0.080	2.5 / 450
9CSDGE-40□-C	9CSDGE-40□-L	40	1φ220	50	4	Cont.	90-1400	1.50	0.150	2.50	0.250	0.70	0.070	2.5 / 450
			1φ240					1.80	0.180	3.00	0.300	0.72	0.072	

- 1) 모터 모델명 \* 자리에는 전압코드가 들어갑니다.
- 2) 전압코드 A, B, C, D, E는 TP(Thermal Protector) 부착 사양입니다.
- 3) 스피드 컨트롤 클러치&브레이크 모터는 감속기를 부착하여 사용하여야 합니다. (모터 출력축: Gear Type Shaft)

### 감속기 부착 시 최대허용토크

Motor Model	Gear box Model	회전 속도 r/min	전압 V	주파수 Hz	감속비	2	3	3.6	5	6	7.5	9	10	12.5	15	18	20	25	30	36	40	50	60	75	90	100	120	150	180	200			
9CSDG*-40G	9GBK □ BMH	1200	110	60	kgfcm	4.4	6.6	7.9	10.9	13.1	16.4	19.7	21.9	27.3	32.8	39.4	39.4	49.3	59.1	71.0	78.8	89.1	100.0	100.0	100.0	100.0	100.0	100.0	100.0	100.0	100.0		
					N.m	0.43	0.64	0.77	1.07	1.29	1.61	1.93	2.14	2.68	3.21	3.86	3.86	4.83	5.79	6.95	7.73	8.73	9.80	9.80	9.80	9.80	9.80	9.80	9.80	9.80	9.80	9.80	9.80
					220/240	50	kgfcm	4.1	6.1	7.3	10.1	12.2	15.2	18.2	20.3	25.3	30.4	36.5	36.5	45.6	54.8	65.7	73.0	82.5	99.0	100.0	100.0	100.0	100.0	100.0	100.0	100.0	100.0
		N.m	0.40	0.60	0.71	0.99	1.19	1.49	1.79	1.98	2.48	2.98	3.57	3.58	4.47	5.37	6.44	7.15	8.09	9.70	9.80	9.80	9.80	9.80	9.80	9.80	9.80	9.80	9.80	9.80	9.80	9.80	
		90	110	60	kgfcm	1.3	1.9	2.3	3.2	3.9	4.9	5.8	6.5	8.1	9.7	11.7	14.6	17.5	21.0	23.4	26.4	31.7	39.6	47.5	52.8	63.4	79.2	95.0	100.0	100.0	100.0	100.0	100.0
					N.m	0.13	0.19	0.23	0.32	0.38	0.48	0.57	0.64	0.79	0.95	1.14	1.43	1.72	2.06	2.29	2.59	3.10	3.88	4.66	5.17	6.21	7.76	9.31	9.80	9.80	9.80	9.80	9.80
220/240	50				kgfcm	1.1	1.7	2.0	2.8	3.4	4.3	5.1	5.7	7.1	8.5	10.2	12.8	15.3	18.4	20.4	23.1	27.7	34.7	41.6	46.2	55.4	69.3	83.2	92.4	92.4	92.4	92.4	
N.m	0.11	0.17	0.20	0.28	0.33	0.42	0.50	0.56	0.69	0.83	1.00	1.00	1.25	1.50	1.80	2.00	2.26	2.72	3.40	4.07	4.53	5.43	6.79	8.15	9.06	9.06	9.06	9.06	9.06				

Motor Model	Gear box Model	회전 속도 r/min	전압 V	주파수 Hz	감속비	2	3	3.6	5	6	7.5	9	10	12.5	15	18	20	25	30	36	40	50	60	75	90	100	120	150	180	200		
9CSDG*-40P	9PBK □ BH	1200	110	60	kgfcm	4.4	6.6	7.9	10.9	13.1	16.4	19.7	21.9	24.6	29.6	35.5	39.4	44.6	53.5	64.2	71.3	89.1	106.9	119.5	143.4	159.3	191.2	200.0	200.0	200.0		
					N.m	0.43	0.64	0.77	1.07	1.29	1.61	1.93	2.14	2.41	2.90	3.48	3.86	4.37	5.24	6.29	6.99	8.73	10.48	11.71	14.05	15.61	18.73	19.60	19.60	19.60	19.60	19.60
					220/240	50	kgfcm	4.1	6.1	7.3	10.1	12.2	15.2	18.2	20.3	22.8	27.4	32.9	36.5	41.3	49.5	59.4	66.0	82.5	99.0	110.6	132.8	147.5	177.0	200.0	200.0	200.0
		N.m	0.40	0.60	0.71	0.99	1.19	1.49	1.79	1.98	2.24	2.68	3.22	3.58	4.04	4.85	5.82	6.47	8.09	9.70	10.84	13.01	14.46	17.35	19.60	19.60	19.60	19.60				
		90	110	60	kgfcm	1.3	1.9	2.3	3.2	3.9	4.9	5.8	6.5	7.3	8.8	10.5	11.7	13.2	15.8	19.0	21.1	26.4	31.7	35.4	42.5	47.2	56.6	70.8	85.0	94.4	94.4	
					N.m	0.13	0.19	0.23	0.32	0.38	0.48	0.57	0.64	0.72	0.86	1.03	1.14	1.29	1.55	1.86	2.07	2.59	3.10	3.47	4.16	4.63	5.55	6.94	8.33	9.25		
220/240	50				kgfcm	1.1	1.7	2.0	2.8	3.4	4.3	5.1	5.7	6.4	7.7	9.2	10.2	11.6	13.9	16.6	18.5	23.1	27.7	31.0	37.2	41.3	49.6	62.0	74.3	82.6		
N.m	0.11	0.17	0.20	0.28	0.33	0.42	0.50	0.56	0.63	0.75	0.90	1.00	1.13	1.36	1.63	1.81	2.26	2.72	3.04	3.64	4.05	4.86	6.07	7.29	8.09							

- 1) 모터 모델명 \* 자리에는 전압코드가 들어갑니다.
- 2) 감속기 모델명 □ 안에는 감속비가 들어갑니다.
- 3) 위의 표에서 색칠된 범위의 감속비를 선택했을 때 감속기의 출력축은 모터의 출력축과 같은 방향으로 회전합니다. 흰색 바탕 범위의 감속비에서는 감속기 출력축은 모터 출력축의 회전방향과 반대방향으로 회전합니다.

## Dimensions

### GEARED MOTOR

#### G TYPE GEARBOX

- MOTOR MODEL:  
9CSDG□-40G-C

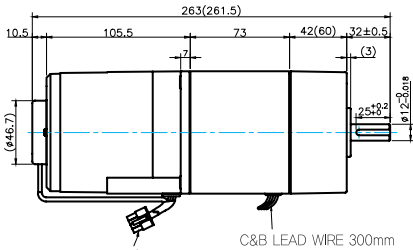

LEAD WIRE ASS'Y 300mm  
MOTOR UL STYLE NO.3271 AWG NO.20  
T,G UL STYLE NO.1430 AWG No.24

- GEARBOX MODEL:  
9GBK□BMH

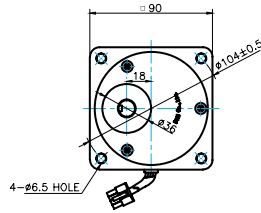

#### GEARBOX OUTPUT SHAFT

MODEL	SPEC
KEY TYPE	32±0.5
9GBK□BMH	25±0.2 φ12±0.08

#### 42(60)-Table1

SIZE(mm)	GEAR RATIO
42	9GBK2BMH - 9GBK18BMH
60	9GBK20BMH - 9GBK200BMH

#### KEY SPEC

GEARBOX	
10.03	2.5±0.1
25±0.2	4-0.03

#### P TYPE GEARBOX

- MOTOR MODEL:  
9CSDG□-40P-C

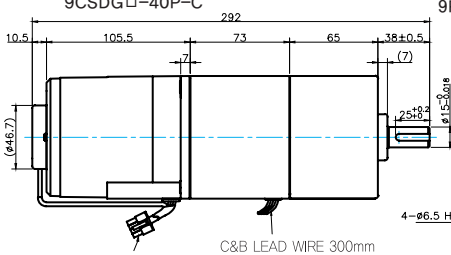

LEAD WIRE ASS'Y 300mm  
MOTOR UL STYLE NO.3271 AWG NO.20  
T,G UL STYLE NO.1430 AWG No.24

- GEARBOX MODEL:  
9PBK□BH

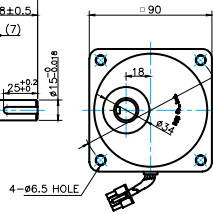

- GEARBOX MODEL:  
9PFK□BH

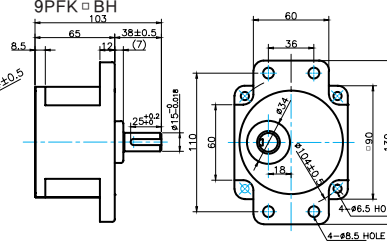

#### GEARBOX OUTPUT SHAFT

MODEL	SPEC
KEY TYPE	38±0.5 (7)
9PBK□BH 9PFK□BH	25±0.2 φ12±0.08

#### KEY SPEC

GEARBOX	
10.03	3±0.1
25±0.2	5-0.0

#### 중간감속기

- MODEL:  
9XD10□□

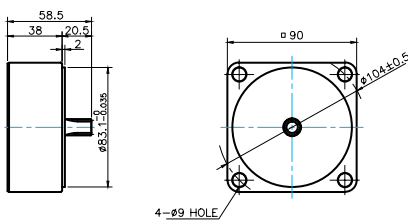

#### WEIGHT

PART		WEIGHT(kg)
MOTOR		3.90
GEAR BOX	9GBK2BMH - 9GBK18BMH	0.78
	9GBK20BMH - 9GBK40BMH	1.10
	9GBK50BMH - 9GBK200BMH	1.20
	9PB(F)K2BH - 9PB(F)K10BH	1.28
	9PB(F)K12.5BH - 9PB(F)K20BH	1.30
	9PB(F)K25BH - 9PB(F)K60BH	1.45
	9PB(F)K75BH - 9PB(F)K200BH	1.47
	9XD10□□	0.60

\*출력 FLANGE와 SHAFT는 별매입니다.

## Motor Images

